



Ramblings Part 6 (Continued)

C. Limestone Caps not all Created Equal

In a previous cover letter regarding flashing, I discussed self adhesive flashing and stainless steel drip edges. I showed photos of my bank (see photo on right) and BIA's Detail from Tech Note 21B (see illustration bottom right). As a follow up to this discussion while a guest at a local golf course (I'm working all the time!), I noticed the recent remodeling and careful detailing of the new masonry and the existing older brick and limestone detailing of the clubhouse. This designer was very careful in matching the original detailing, but he/she updated the limestone cap and flashing detail for the 21st century. Great work!

OLD CAP DETAIL



POORLY DETAILED COPING



My Bank: (Note the efflorescence, and the flush limestone cap- it should have had 1 1/2" projection or a drip edge and flashing under the cap)

PROPER DETAIL

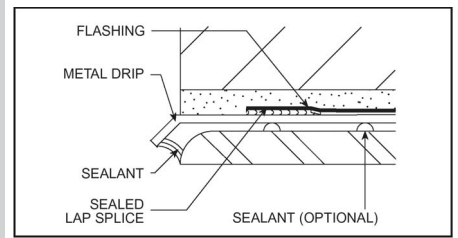

**BIA Detail, Technical Note 21B
Revised, April 2002, Figure 1.**

NEW FLUSH CAP WITH EXPOSED DRIP EDGE & FLASHING

